

high pressure manual vises

Arnold 5X with Mechanical Booster

Designed for 5-axis machining, ARNOLD 5X high pressure vises feature high jaws to hold parts far above the vise bed and allow tool access from all sides.

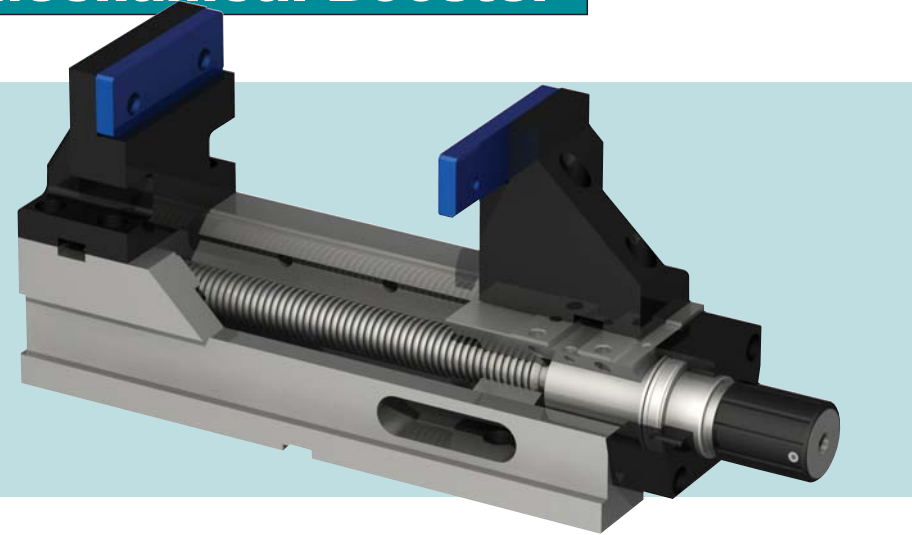

- Main components in nodular cast iron.
- 0.01mm (0.0004") clamping repeatability.
- Designed in two sizes with adjustable force of up to 3 tons (6,600 lbs) on the highest part.
- High pressure mechanical intensifier.
- High pressure mechanical spindle does not require any maintenance, as long as the appropriate coolants are used.
- Optional power regulator.
- Constant clamping force ensures constant and repeatable positioning of work pieces day after day.
- Ideal for long machining cycles on 5 axis machining centers.

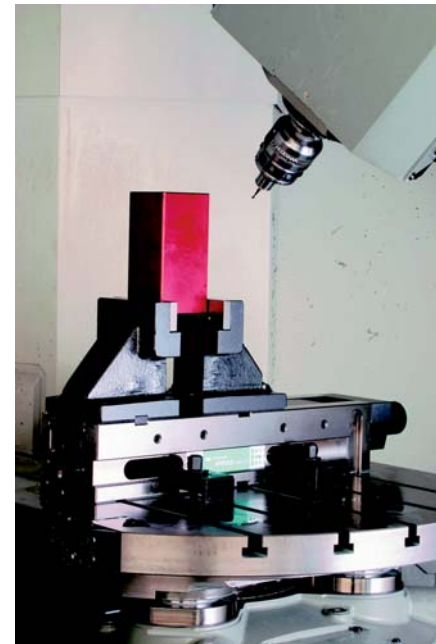

- Large side openings for easy chip removal.
- ARNOLD 5X vise jaw carriers can be used with a variety of standard and custom jaws.
- The jaws are manufactured in cast iron for optimal vibration dampening and long-term stability.

- Can be clamped to the table using the standard toe clamps or with screws through the inside of the body.
- Can be converted to hold parts closer to the vise bed by using standard Arnold step jaws (Parts No. 961-181-125 and 941-150-125).



- Can be used with optional machinable soft jaws to hold castings, forgings and other irregular shapes



Size	125 M	125 L
Arnold 5X	050 121 125	
Arnold 5X with regulator	050 131 125	050 130 125
Clamping force (kg / lbs)	3000 / 6600	3000 / 6600
A (mm / inches)	410 / 16.14	480 / 18.90
B (mm / inches)	518 / 20.39	589 / 23.19
B with regulator (mm / inches)	548 / 21.57	618 / 24.33
C - 0.02 (mm / inches)	100 / 3.94	100 / 3.94
D (mm / inches)	220 / 8.66	250 / 9.84
E (mm / inches)	126 / 4.96	126 / 4.96
J (mm / inches)	140 + 0.02 / 5.51	152 + 0.02 / 5.91
M H7 (mm / inches)	20 / 0.79	20 / 0.79
N (mm / inches)	40 / 1.57	40 / 1.57
Weight (kg / lbs)	44 / 97	49 / 108
Clamping field R	0-206/0-8.11	38-244/1.50-9.61

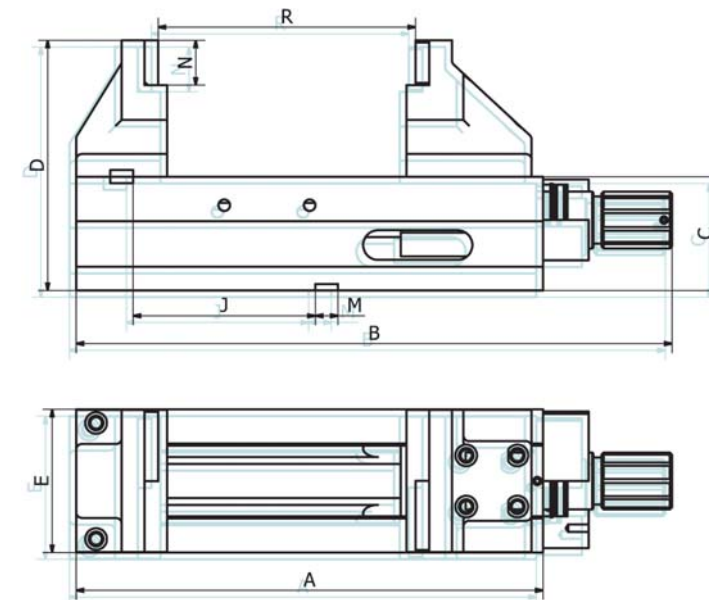

Supplied with

- base body
- mechanical spindle
- 1 set of cast iron jaws
- 1 set of plain jaws
- 1 handle
- 4 toe clamps
- instruction manual

