

self centering manual vises

Arnold SC self-centering

ARNOLD SC high precision vises are compact and hold the part high above the vise bed for improved tool access - ideal for 5 axis machining centers.

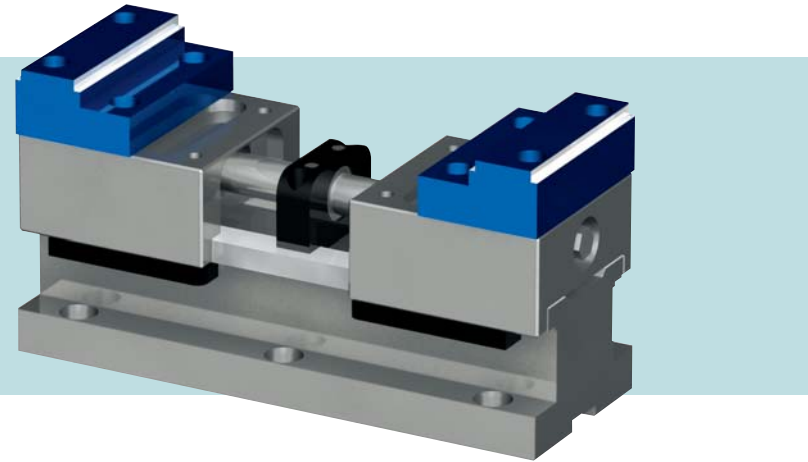

- Self-centering high precision vises.
- 0.01mm (0.0004") clamping repeatability.
- 0.02/0.03 mm (0.0008/0.0012") accuracy on centering.
- Designed to work on machining centers with small tables and in 5-axis applications.
- Compact design with exterior guides that avoids deformation as the clamping force is distributed throughout the width.
- Clamping force from 2 to 4 tons (4,400 to 8,800 lbs), depending on torque.
- Threaded right-left spindle, which can be operated from both sides of the vise.
- Optional soft jaws available.

Interchangeable jaws can reach a height of 125mm (4.92") to reduce the risk of collisions with the machine turrets or the rotation of the table.

Clamping possibilities

Possibility of positioning the jaws in two locations. Arnold SC vises can be used for reverse (inside-out) clamping.

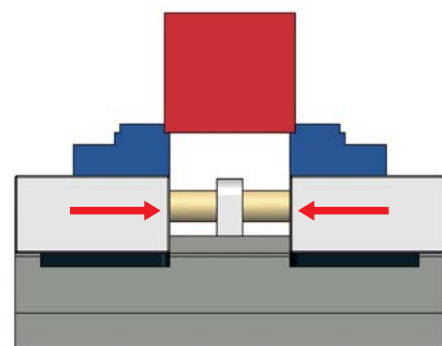

Clamping field 0₁

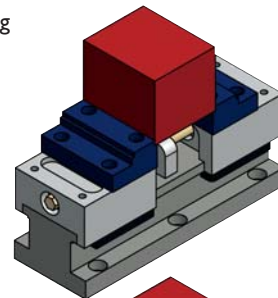

Interior clamping field 0₅

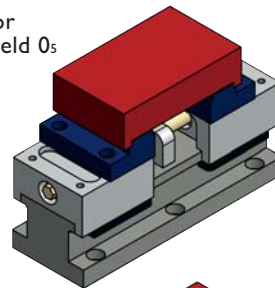

Clamping field 0₂

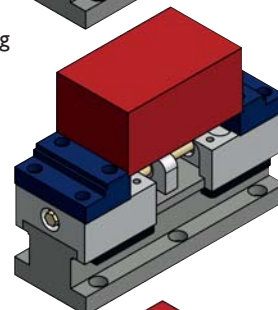

Interior clamping field 0₆

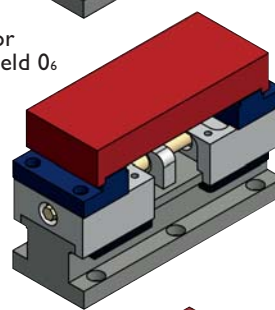

Clamping field 0₃

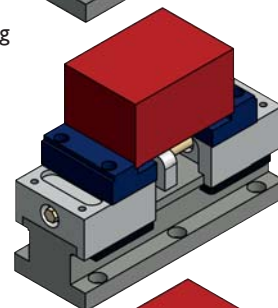

Interior clamping field 0₇

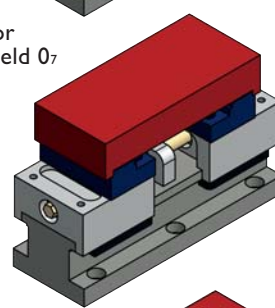

Clamping field 0₄

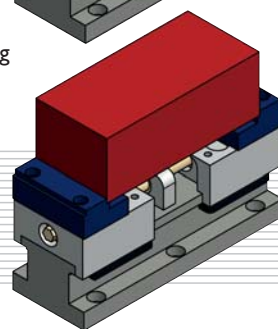

Interior clamping field 0₈

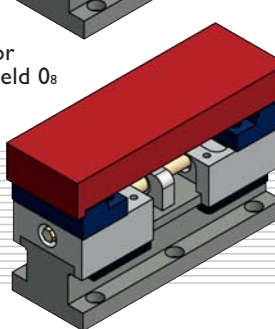

Size	090	125
Arnold SC	050 200 090	050 200 125
A (mm / inches)	250 / 9.84	350 / 13.78
B (mm / inches)	115 / 4.53	165 / 6.50
C (mm / inches)	20H7 / 0.79	20H7 / 0.79
D (mm / inches)	100 / 3.94	103 / 4.06
E (mm / inches)	125 / 4.92	125 / 4.92
F (mm / inches)	90 / 3.54	125 / 4.92
G (mm / inches)	30 / 1.18	30 / 1.18
H (mm / inches)	5 / 0.18	5 / 0.18
I (mm / inches)	3 / 0.12	4 / 0.16
J (mm / inches)	90 / 3.54	125 / 4.92
K (mm / inches)	133 / 5.24	133 / 5.24
Weight (kg / lbs)	14.3 / 32	30 / 66
Clamping field 0 ₁ (mm / inches)	12-76 / 0.47-2.99	14-108 / 0.55-4.25
Clamping field 0 ₂ (mm / inches)	80-144 / 3.15-5.67	104-198 / 4.09-7.80
Clamping field 0 ₃ (mm / inches)	60-124/2.36-4.88	84-178/3.31-7.01
Clamping field 0 ₄ (mm / inches)	129-192/5.08-7.56	174-268/6.85-10.55
Clamping field 0 ₅ (mm / inches)	64-128/2.52-5.04	82-176/3.23-6.93
Clamping field 0 ₆ (mm / inches)	132-196/5.20-7.72	172-266/6.77-10.47
Clamping field 0 ₇ (mm / inches)	112-176/4.41-6.93	152-246/5.98-9.69
Clamping field 0 ₈ (mm / inches)	180-238/7.09-9.37	242-336/9.53-13.23

The clamping force depends on the torque applied to the handle.

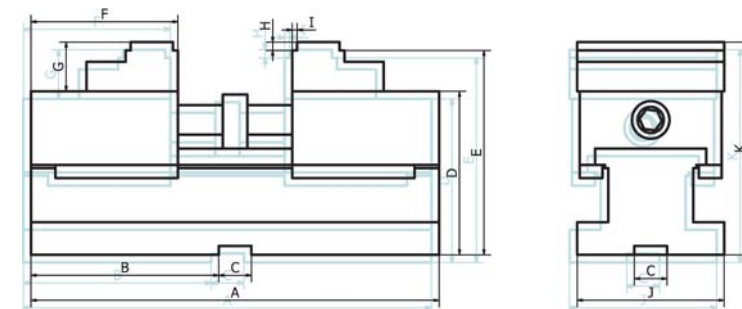

Supplied with:

- base body
- mechanical spindle without high pressure
- 1 set of jaws
- 1 handle
- 4 toe clamps
- instruction manual

